

LEGEND

ASP	ASPHALT	HW	HEADWALL	oLGT	LIGHT	ANCHOR
BLDG	BUILDING	MIN	MINIMUM	COV	COVERED	RADIUS
CALC	CALCULATED	MH	MANHOLE		DECK	R.O.W.
MEAS	MEASURED	OH	OVERHANG		CONCRETE	SAN
CH	CHORD		POWER LINE		WALL	STM
LNG	LONG CHORD	PVMT	PAVEMENT		FENCE	UTIL
d	DEFLECTION	W/TAN	WITH TANGENT	POR	PORCH	AC
Δ	DELTA	RES	RESIDENCE			S.F.
ESMT	EASEMENT					¢
						SQ. FEET
						CENTERLINE

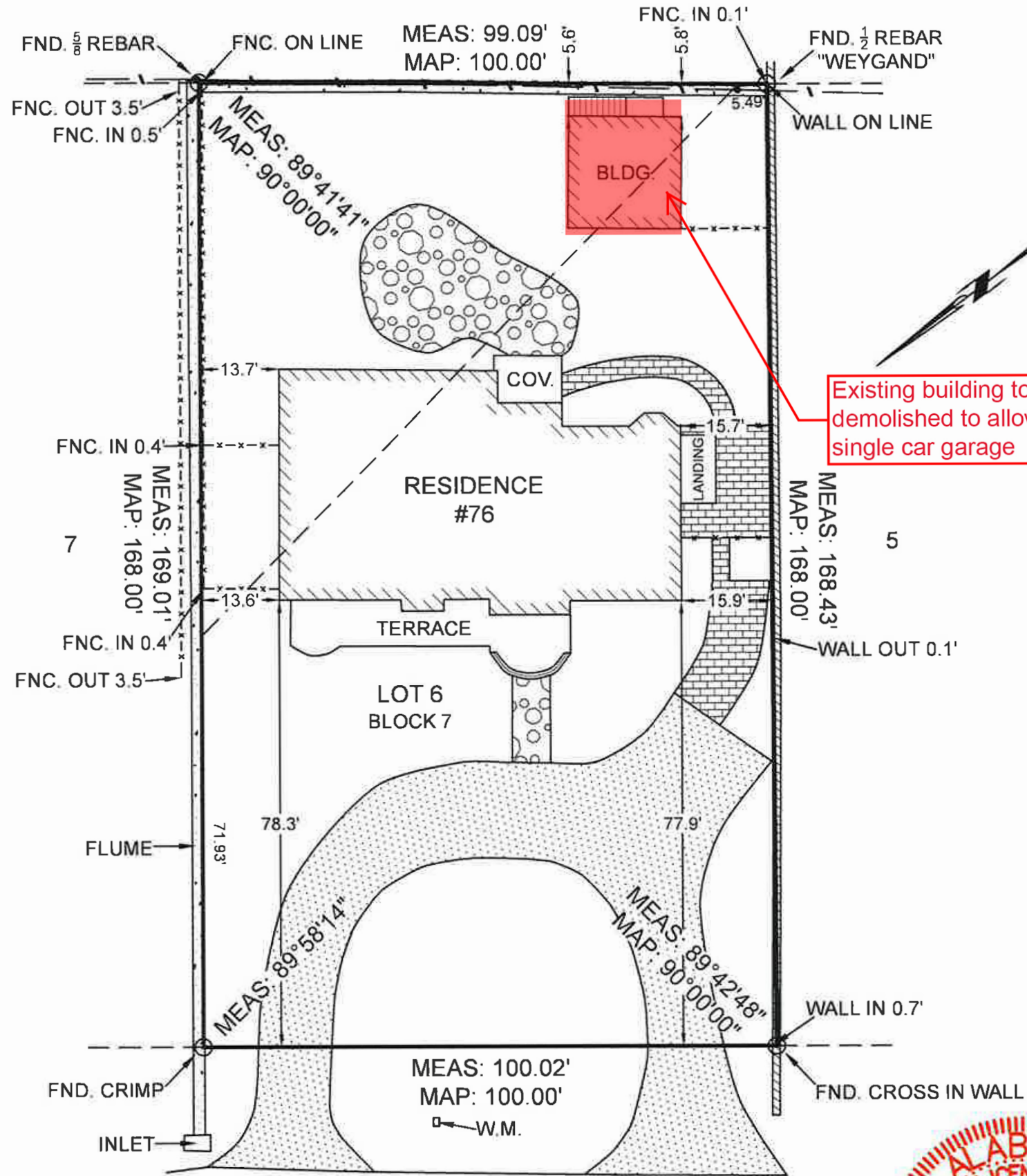

Existing building to be demolished to allow for new single car garage

COUNTRY CLUB BOULEVARD
(60' R.O.W.)



STATE OF ALABAMA)
JEFFERSON COUNTY)

"Property Boundary Survey"

I, Ray Weygand, a Registered Land Surveyor, hereby certify to the purchaser of this property at this time, that I have surveyed Lot 6, Block 7, Country Club Gardens & Matthews Randolph Development Company 1st Addition to Country Club Gardens as recorded in Map Volume 15 & 17, Page 10 & 87, in the Office of the Judge of Probate, Jefferson County, Alabama. I hereby state that all parts of this survey and drawing have been completed in accordance with the current requirements of the Standards of Practice for Surveying in the State of Alabama to the best of my knowledge, information and belief, according to my survey of August 11, 2023. Survey invalid if not sealed in red.

Order No.: 20231103
Purchaser:
Address: 76 Country Club Boulevard

Ray Weygand, Reg. L.S. #24973
169 Oxmoor Road Homewood, AL 35209
Phone: (205) 942-0086 Fax: (205) 942-0087
Copyright ©



Note: (a) No title search of the public records has been performed by this firm and land shown hereon was not abstracted for easements and/or rights-of-way, recorded or unrecorded. The parcel shown hereon is subject to setbacks, easements, zoning, and restrictions that may be found in the public records of said county and/or city. (b) All bearings and/or angles, are deed/record map and actual unless otherwise noted. (c) Underground portions of foundations, footings, and/or other underground structures, utilities, cemeteries or burial sites were not located unless otherwise noted. (d) The shown north arrow is based on deed/record map. (e) This survey is not transferable. (f) Easements not shown on recorded map are not shown above.