

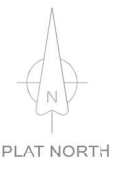

SCALE 1"=30'  
 ASBUILT SURVEY  
 SITE ADDRESS  
 2923 BALMORAL ROAD

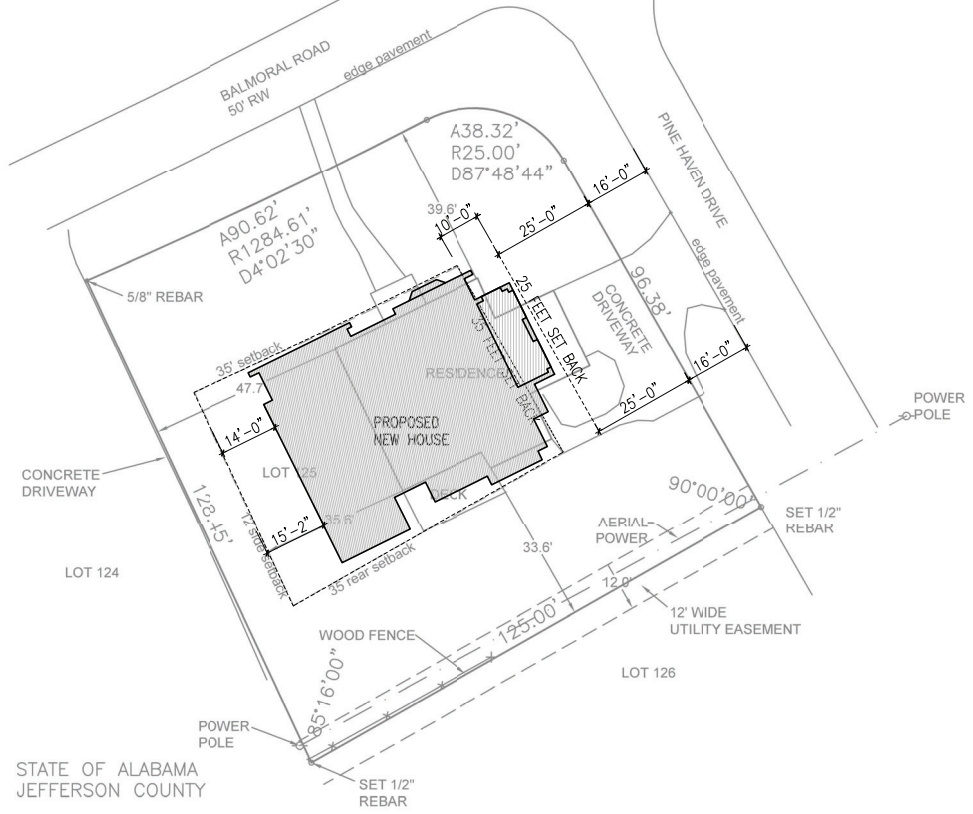

PLAT NORTH



STATE OF ALABAMA  
 JEFFERSON COUNTY

I, James M. Ray, a Registered Land Surveyor in the State of Alabama, hereby certify that all parts of this survey and plat (or drawing) have been completed in accordance with the requirements of the Standards for the Practice of Surveying in the State of Alabama, being more particularly described as follows, to-wit: Lot 125 PINE CREST Subdivision as shown in the office of the Judge of Probate of JEFFERSON County, Alabama in map book 18 page 64

I, further certify that the building now erected on said lot is within the boundaries of the same, except as shown above, that there are no encroachments by buildings except as shown above, that there are not joint driveways over or across said lot visible on the surface, or structures or supports, thereof, including poles, anchors or guy wires over or across said premises, except as shown above.

According to my survey this the 1ST DAY OF JULY 2021.

James M. Ray, Ala. Reg. No. 18383  
 Ray and Gilliland, P. C., Ala. Board Cert. No. CA-0114-LS



Note: No title search of the public records has been performed by this firm and land shown hereon was not abstracted for easements and /or rights-of-way, recorded or unrecorded. The parcel shown hereon is subject to setbacks, easements, zoning, and restrictions that may be found in the public records of said county and/or city. Underground portions of foundations and footings and/or other underground structures, utilities, cemeteries or burial sites were not located unless otherwise noted. We do not look for underground sewer or flip manhole covers. This survey is not transferable and may only be used by the person/company that pays for it at time of survey.

<b>RAY &amp; GILLILAND, P.C.</b>	
122 NORTH CALL-OUN STREET P.O. BOX 1183 SYLACAUGA, ALABAMA 35150	TEL NO. (256) 245-3243 FAX NO. (256) 245-3202
DRAWN BY: JMR	FILE: ERICAONEAL
BOUNDARY SURVEY	SCALE: 1" = 30'